



REGAL
— STUDENTS —



12 Claremont Place

Canterbury, Kent, CT1 3SU

£1,800 PCM



- FOUR DOUBLE BEDROOM STUDENT HOUSE
- OPEN PLAN KITCHEN/COMMUNAL SPACE
- SHOWER AND BATH
- Suitable for Christ Church or UKC
- Half rent July / August
- Located in the city centre
- £500 deposit per room
- Students require an England based guarantor or to pay in advance. Housing hand will be accepted too.



Area Map



Floor Plans

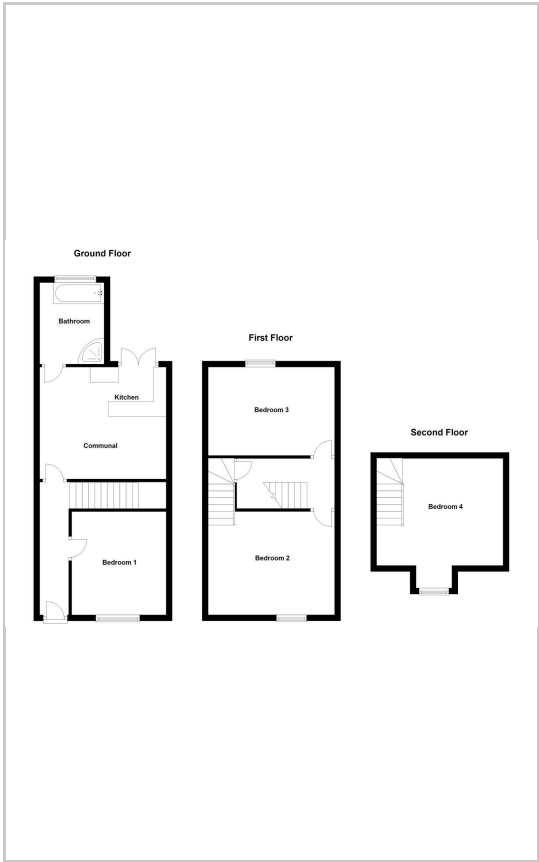

Energy Efficiency Graph



These particulars, whilst believed to be accurate are set out as a general outline only for guidance and do not constitute any part of an offer or contract. Intending purchasers should not rely on them as statements of representation of fact, but must satisfy themselves by inspection or otherwise as to their accuracy. No person in this firms employment has the authority to make or give any representation or warranty in respect of the property.

57 Castle Street, Canterbury, Kent, CT1 2PY
Tel: 01227 767200 Email: lettingssales@regal-estates.co.uk